



P-5 TW

Tunable White LED Wash Light



Description

The P-5 TW is a tunable white output version of the color P-5, which is the most well-known and reputed IP65 LED wash in the lighting industry. It is perfect for creating even coverage at a high light output. The P-5 TW uses 16bit dimming performance, it is completely upgradeable through firmware updates and it offers a full variety of beam angles for medium throws via interchangeable lenses.

Features and benefits

- ✓ High-performance IP65 white LED light source
- ✓ 21958 lumens in 420W
- ✓ 2200K - 5300K CTC control
- ✓ Practically maintenance-free
- ✓ 43°, 21°, and 15° interchangeable lenses
- ✓ DMX, RDM, and wireless control
- ✓ Accurate 16bit dimming performance
- ✓ Flicker-free / Programmable scenes

Certifications & classifications

IP65

RoHS



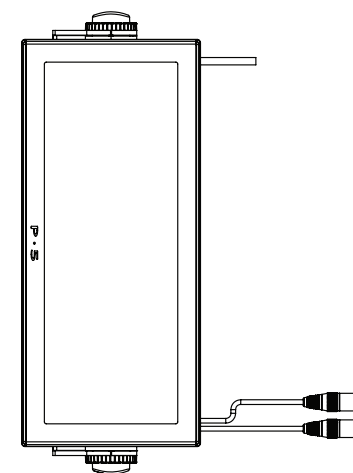
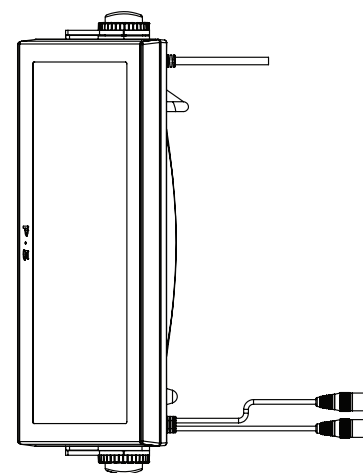
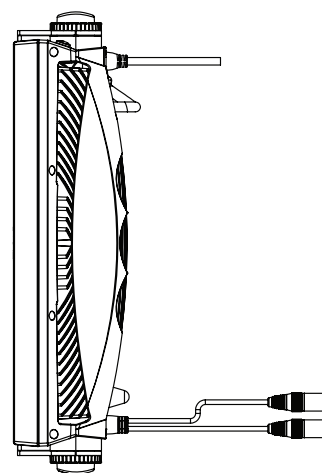
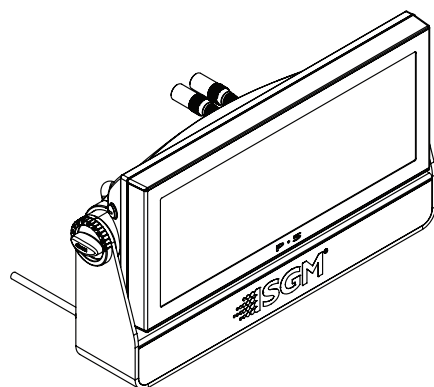
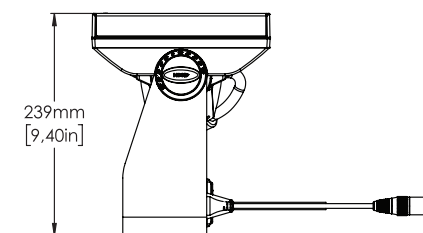
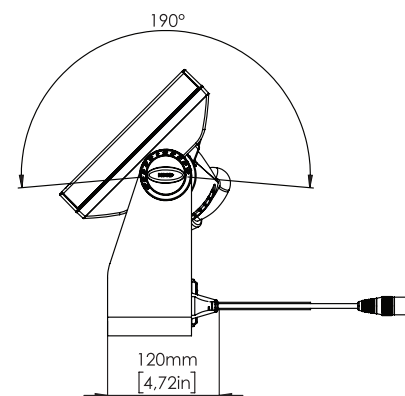
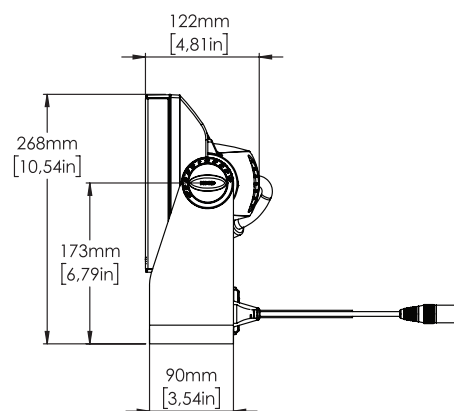
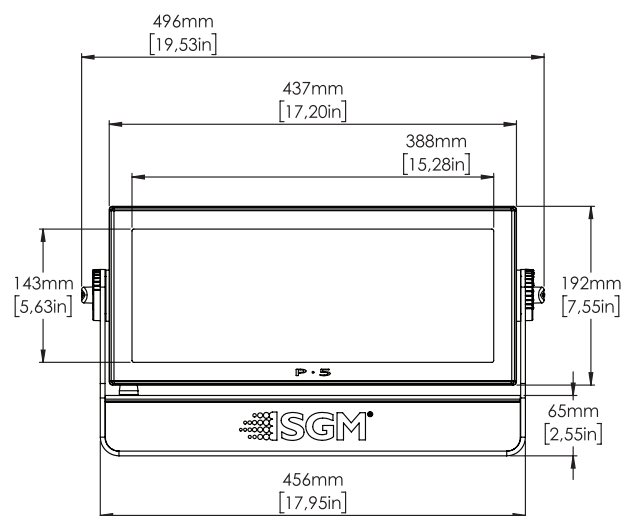

Specification

Optical Data	LED expected lifetime	50,000 hours
	Lens	15° 21° 43°
	Lightsources	44 x high-power 10W white LEDs (2,200K - 5,300K)
Photometric	Beam angle(s)	14° (with 15° lens) 26° (with 21° lens) 35° (with 43° lens)
	Color temperature range	2200K - 5300K
	CRI @ 3200K	84
	CRI typical	87
	Efficacy	49 lm/W
	Light output all LEDs on	21958 lm
	Lux @ 10m	1678 lux
	Lux @ 3m	3978 lux
	Lux @ 5m	6712 lux
	Maximum Field Angle	79 °
	Minimum Field Angle	33 °
Physical	Color options	Black - RAL 9004 Custom color - Any RAL White - RAL 9010
	Effective Projected Area	1.72 Square ft
	IP class	IP65
	Lens material	PE and tempered glass front
	Material	Aluminium
	Net dimensions	497 x 268 x 122 mm
	Net dimensions inches	19.6 x 10.6 x 4.8 inches
	Net weight	8.9 kg (19.6 lbs)
Features	Dimming	Electronic
	Strobe	Ultra-high-speed strobe effects
	Tilt	0 - 190°
Electrical	AC power, max.	190 - 264V 50/60Hz
	AC Power, nominal	208 - 240V 50/60Hz
	Electrical Protection	Overload protection
	Max Inrush Current	45 A

	Max power consumption	450 W
	Power factor	0.98 PF (230 V)
	Power Supply Unit	Auto-ranging electronic switch-mode
	Standby power consumption	8 W
	Typical power consumption	420 W
Programming and Control	16-bit control	Dimmer
	Cabled DMX	5 pin XLR input/output
	DMX channels	2, 4, 6 or 8
	DMX modes	4
	Protocol	USITT DMX512A Wireless DMX (LumenRadio) RDM ANSI E1.20
	Setting and addressing	OLED graphical display / 4 buttons RDM ANSI E1.20 RFID Standalone mode
	Standalone mode	Quick Color Standalone mode programmable via RFID Up to 24 programmable scenes
	Wireless DMX	Lumen Radio with RDM
Connections	DMX data in/out	IP65 XLR 5-pin cable 0.5m
	Power	Power cable 1 meter with bare ends
Installation	Mounting point	2 x 2 quarter-turn locking points for one or two Omega brackets
	Orientation	Any
	Rigging possibilities	Floor stand (included) or hanging (Omega clamps included)
	Safety features	Bottom mount for safety wire Minimum distance to combustible materials: 0.3 meter (11 in).
Thermal	Cooling	Active, Forced Air, Temperature- regulated
	Humidity (max.)	98 %
	Temperature range, Operating	-40°C to 50°C
	Temperature range, Start-up	-20°C to 50°C
	Temperature range, Storage	-40°C to 80°C
	Thermal Protection	Automatic overtemperature protection
Included items	Included items	Wireless DMX antenna Mounting bracket (incl. screws) 2 Omega bracket with quarter-turn fasteners

Conforms To	CE - 2014/30/EU: EMC Directive	EN 55103-1 EN 55103-2 EN 55015 EN 61547 EN 61000-3-2 EN 61000-3-3
	CE - 2014/35/EU: Low Voltage Directive	EN 60598-1 EN 60598-2-17 EN 62471 EN 60529
	RoHS2 Directive UL	2011/65/EU UL Std. 1573
Certified To	CSA	CSA Std. C22.2 No. 166

NOTES:

Due to continuous improvements and innovations, specifications may change without notice.

LEDs' expected lifetime provided by manufacturer and obtained under manufacturer's test conditions.

Zoom range defined as a minimum beam angle to a maximum field angle.

Photometric measurements obtained with Goniometer Scan / SGM Illumination Lab 1.6.0.0.

Lumen output in pixel products is calculated.

Ordering information

Qty	Product name	Item number
<input type="checkbox"/>	P-5 TW Wash, 21deg, Std, BL	80030519
<input type="checkbox"/>	P-5 TW Wash, 15deg, Std, BL	80030522
<input type="checkbox"/>	P-5 TW Wash, 43deg, Std, BL	80030523
<input type="checkbox"/>	P-5 TW Wash, 43deg, Std, CU	80030559
<input type="checkbox"/>	P-5 TW Wash, 21deg, Std, CU	80030560
<input type="checkbox"/>	P-5 TW Wash, 15deg, Std, CU	80030548
<input type="checkbox"/>	P-5 TW Wash, 43deg, Std, WH	80030555
<input type="checkbox"/>	P-5 TW Wash, 21deg, Std, WH	80030557
<input type="checkbox"/>	P-5 TW Wash, 15deg, Std, WH	80030558
<input type="checkbox"/>		
	Accessories	Item number
<input type="checkbox"/>	P-5 Lens Kit, 15°	83061116
<input type="checkbox"/>	P-5 Lens Kit, 21°	83061117
<input type="checkbox"/>	P-5 Lens Kit, 43°	83061118
<input type="checkbox"/>	BCC-2 Dual Bracket	83060603
<input type="checkbox"/>	BCC-4 Quad Bracket	83060604
<input type="checkbox"/>	Omega Bracket with 1/4-turn fasteners	83060602
<input type="checkbox"/>	4-way Barndoors for P-5, i-5, X-5, Q-7	83061120
<input type="checkbox"/>	8-way Barndoors for P-5, i-5, X-5, Q-7	83061121
<input type="checkbox"/>	Accessory Holder for P-5 & i-5	83061119
<input type="checkbox"/>	Color Frame for P-5, Q-7, X-5, i-5	83061122
<input type="checkbox"/>	Floor Stand for P-5, X-5 & Q-7	83060610
<input type="checkbox"/>	Flight Case for 4 pcs of P-5/Q-7/X-5	82051501
<input type="checkbox"/>	Flight Case for 4 pcs of P-5/Q-7/X-5 incl. barndoors	82051502
<input type="checkbox"/>	SGM USB uploader cable	83062011
<input type="checkbox"/>	Vacuum Test Kit	83061136
<input type="checkbox"/>	A-4	80070217
<input type="checkbox"/>	Diffusion filter for P-5, i-5 - elliptical horizontal, external	83061027
<input type="checkbox"/>	Diffusion filter for P-5, i-5 - elliptical vertical, external	83061028
<input type="checkbox"/>	Diffusion filter for P-5, i-5 - medium, external	83061025
<input type="checkbox"/>	Diffusion filter for P-5, i-5 - wide, external	83061026
<input type="checkbox"/>	RDM Addressing Tool	
<input type="checkbox"/>		



Headquarter [+45 70 20 74 00](tel:+4570207400)

Mail info@sgmlight.com

Website sgmlight.com