

Box truss

Medium duty truss 20.5 x 20.5 plated



Medium duty truss 20.5 x 20.5 plated

- › Standard lengths are 10', 8' and 5'
- › Custom lengths available upon request
- › Equipped with bolts
- › Main chords are 2" OD x 1/8" aluminum
- › Diagonals are 1" OD x 1/8" aluminum
- › Studio version available with 2" OD x 3/16" main chords
- › Available with casters
- › Fabricated by AWS/SFL certified welders

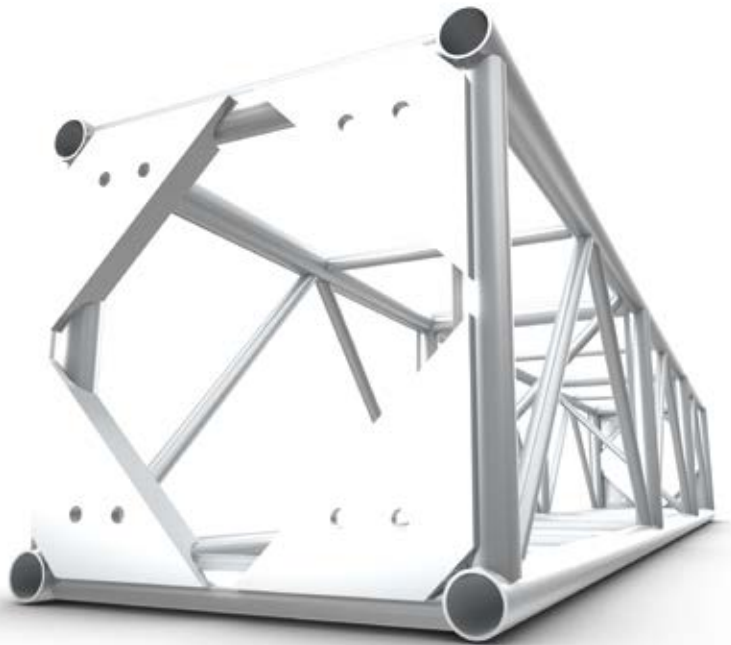

PLAN VIEWS 5-WAY & 6-WAY AVAILABLE

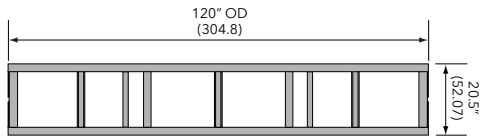

PLAN

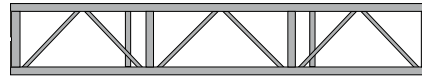

ELEVATION

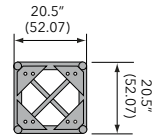

END VIEW

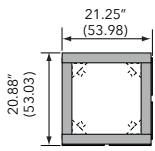

2-WAY CORNER BLOCK

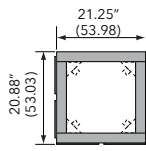

3-WAY CORNER BLOCK

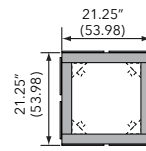

4-WAY CORNER BLOCK

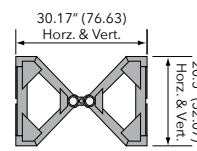

CENTER PIVOT HORIZ. ARTICULATING BLOCK

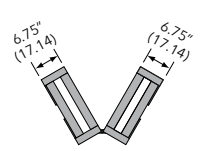

HORIZONTAL VARIABLE CORNER

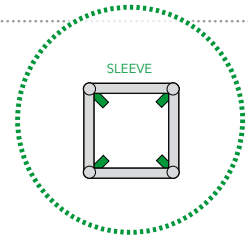

SLEEVE

MAXIMUM ALLOWABLE UNIFORM LOADS

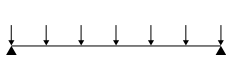

MAXIMUM ALLOWABLE POINT LOADS

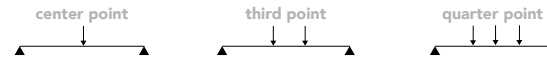

SPAN FT (MTRS)	MAXIMUM ALLOWABLE UNIFORM LOADS			MAXIMUM ALLOWABLE POINT LOADS					
	LOAD LBS/FT	LOAD LBS (KGS)	MAX DEFL. IN.	center point		third point		quarter point	
				LOAD LBS (KGS)	MAX DEFL. IN.	LOAD LBS (KGS)	MAX DEFL. IN.	LOAD LBS (KGS)	MAX DEFL. IN.
10 (3.05)	839	8390 (3806)	0.08	4744 (2152)	0.07	3558 (1614)	0.09	2372 (1076)	0.08
20 (6.09)	230	4600 (2087)	0.34	2306 (1046)	0.27	1729 (784)	0.35	1153 (523)	0.32
30 (9.14)	97	2910 (1320)	0.76	1464 (664)	0.62	1098 (498)	0.78	732 (332)	0.73
40 (12.21)	51	2040 (925)	1.36	1021 (463)	1.13	765 (347)	1.39	510 (231)	1.30
50 (15.24)	29	1450 (658)	2.10	737 (334)	1.80	553 (251)	2.16	369 (167)	2.05

5/8" diameter Grade 8 Bolts with standard washers through 3/8" gusset plates

Note: Deflections reported in the tables on the left are the maximum expected for full loadings (indoors only). All loads are based on 10' (3.05 m) sections. Other section lengths are available. Load tables are reprinted from engineering reports developed by Parkhill, Smith & Cooper, Inc., structural engineers, and apply to truss fabricated after December 1989.

MEDIUM DUTY TRUSS 20.5 X 20.5 PLATED END PLATES EQUIPPED FOR DOUBLE SETS OF BOLTS

PRODUCT DESCRIPTION	ITEM CODE	WEIGHT LBS (KGS)
5 FT MEDIUM DUTY TRUSS	TC 2020-060B	56 (25)
8 FT MEDIUM DUTY TRUSS	TC 2020-096B	77 (35)
10 FT MEDIUM DUTY TRUSS	TC 2020-120B	85 (39)
MEDIUM DUTY 2-WAY CORNER	TC 2020-C2B	31 (14)
MEDIUM DUTY 3-WAY CORNER	TC 2020-C3B	32 (15)
MEDIUM DUTY 4-WAY CORNER	TC 2020-C4B	39 (18)
MEDIUM DUTY 5-WAY CORNER	TC 2020-C5B	52 (24)
MEDIUM DUTY 6-WAY CORNER	TC 2020-C6B	58 (27)
5 FT MEDIUM DUTY TRUSS (studio)	TC 20ST-060B	66 (30)
8 FT MEDIUM DUTY TRUSS (studio)	TC 20ST-096B	91 (42)
10 FT MEDIUM DUTY TRUSS (studio)	TC 20ST-120B	102 (47)

PRODUCT DESCRIPTION	ITEM CODE	WEIGHT LBS (KGS)
MD ARTICULATING BLOCK HORIZONTAL (center pivot)	TC 2020-AHB	59 (27)
MD ARTICULATING BLOCK VERTICAL (center pivot)	TC 2020-AVB	59 (27)
MD VARIABLE CORNER HOR. (book style with brace)	TC 2020-VHB	45 (21)
MD VARIABLE CORNER VER. (book style with brace)	TC 2020-VVB	45 (21)
MD 2-WAY SLEEVE FOR 12" TOWER	TC 2020-S2B	43 (20)
MD 3-WAY SLEEVE FOR 12" TOWER	TC 2020-S3B	50 (23)
MD 4-WAY SLEEVE FOR 12" TOWER	TC 2020-S4B	56 (26)